

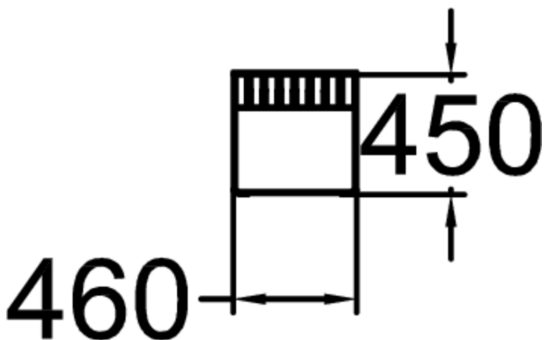

The 061100M model offers a streamlined, backless configuration with optional handrests, allowing for versatile arrangements in smaller spaces or areas with limited seating options. Crafted with precision, the 061100M features glue-laminated northern pine seat planks, available in natural tones or treated with paint or linseed oil for a refined finish. The bench's 8mm metal frame, 45mm in width, is powder-coated in dark grey, black, or customized colours, ensuring durability and resistance to wear. The wooden seat planks are 1800x42x120 in size. The modular design enables seamless integration with other Momentum series elements. Installation options include free-standing, surface fixation, or ground mounting, making the 061100M bench a flexible and stylish choice for various urban and park environments. The Momentum Bench 061100M captures the essence of Scandinavian design with playful yet minimalist elements that create a warm, inviting aesthetic. Designed for urban environments, this bench prioritizes modularity and adaptability, making it ideal for diverse urban and

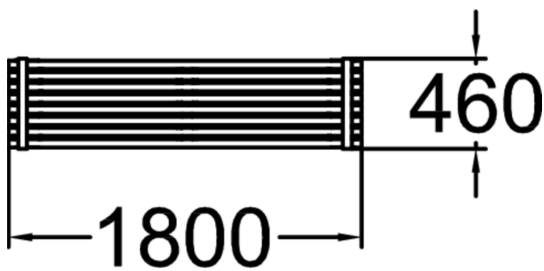

Product length, mm	1800
Product width, mm	460
Product height, mm	450
Foundation options	ground_anchoring surface_mounting
Wood	🌲 🌲 🌲 ending
Metal	🔩 🔩